

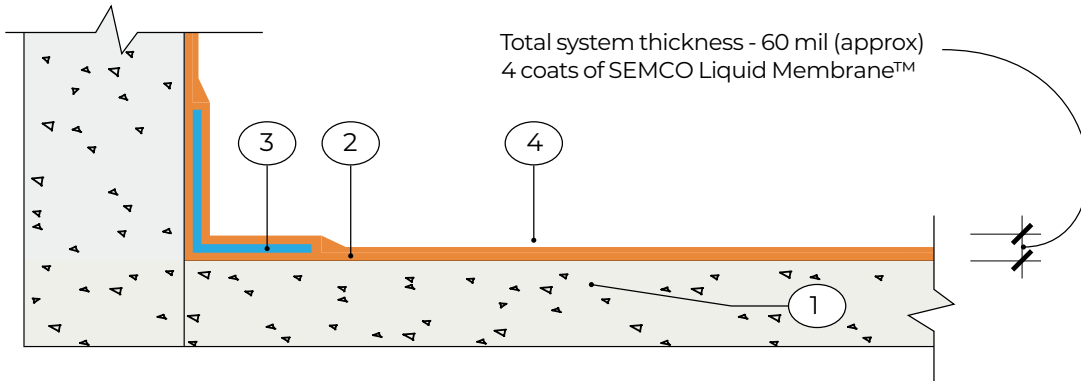



SEMCO Basement waterproofing



Reduces RH up to 75% / vapor transmission rate up to 10 PSI



-  1. Existing substrate - concrete
-  2. SEMCO Liquid Membrane™ - 2 coats, each coat 15 mil. Total thickness - 30 mil (2 coats). Let each coat dry before applying next coat.
-  3. Fabric reinforcement
-  4. SEMCO Liquid Membrane™ - 2 coats, each coat 15 mil. Total thickness - 30 mil (2 coats). Let each coat dry before applying next coat.

